



**RECORD OF TITLE
UNDER LAND TRANSFER ACT 2017
UNIT TITLE
Search Copy**



R. W. Muir
R. W. Muir
Registrar-General
of Land

Identifier **WN23C/385**
Land Registration District **Wellington**
Date Issued 14 October 1983

Prior References
WN6D/525

Supplementary Record Sheet
WN23C/394

Estate Stratum in Freehold
Legal Description Unit D and Accessory Unit 8 Deposited
Plan 55016

Registered Owners
Charlotte Lillian Rae

The above estates are subject to the reservations, restrictions, encumbrances, liens and interests noted below and on the relevant unit plan and supplementary record sheet

11582424.2 Mortgage to Bank of New Zealand - 24.10.2019 at 3:36 pm

Identifier

WN23C/385



**SUPPLEMENTARY RECORD SHEET
UNDER UNIT TITLES ACT 1972**

Search Copy

Identifier

WN23C/394

Land Registration District

Wellington

Date Issued

14 October 1983

Plan Number

DP 55016

Subdivision of

Lot 15 Block F Deposited Plan 467 and Lot 14 Block F Deposited Plan 467

Prior References

WN6D/525

Unit Titles Issued

WN23C/383	WN23C/384	WN23C/385	WN23C/386
WN23C/387	WN23C/388	WN23C/389	WN23C/390
WN23C/391	WN23C/392	WN23C/393	WN44A/333

Interests

OWNERSHIP OF COMMON PROPERTY

Pursuant to Section 47 Unit Titles Act 2010 -

(a) the body corporate owns the common property and

(b) the owners of all the units are beneficially entitled to the common property as tenants in common in shares proportional to the ownership interest (or proposed ownership interest) in respect of their respective units.

The above memorial has been added to Supplementary Record Sheets issued under the Unit Titles Act 1972 to give effect to Section 47 of the Unit Titles Act 2010.

286 Order in Council imposing Building Line Restriction

9264793.1 Notice of change of body corporate operational rules pursuant to Section 106 Unit Titles Act 2010 - 11.12.2012 at 7:00 am

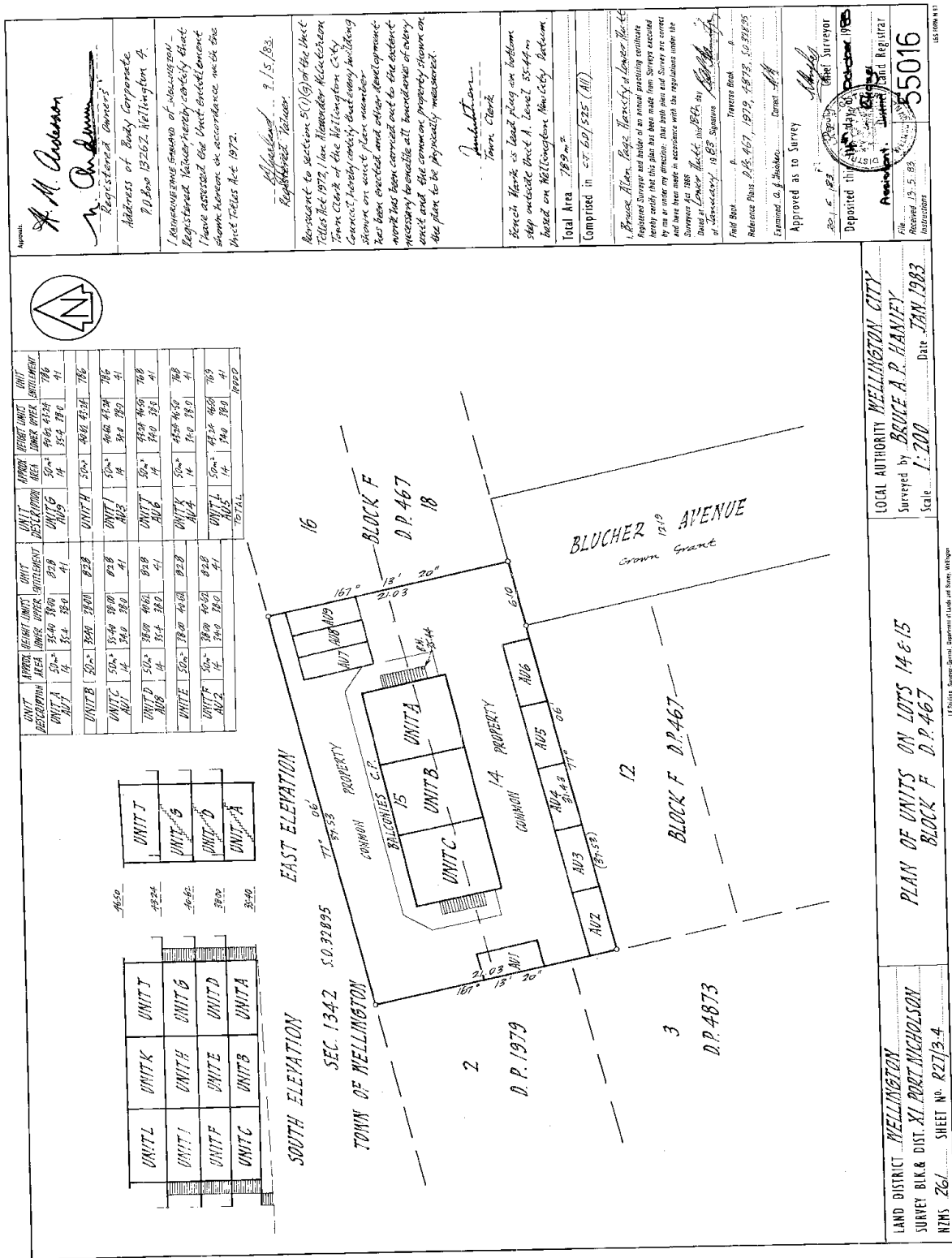

Approved: *A. M. Anderson*
 Registered Owners:
 Address of Body Corporate:
 9 D. P. 13262, Wellington 4.
 I, *Robert James*, of Wellington, Registered Valuer, hereby certify that I have assessed the Unit entitlement shown herein in accordance with the Unit Rules A.C. 1972.
 Dated this 15th day of 1983.
 Registered Valuer.
 Pursuant to section 5(1)(g) of the Unit Rules Act 1972, I, *Robert James*, of Wellington, Town Clerk of the Wellington City Council, hereby certify that the building shown on this plan number *18* has been erected and other development work has been carried out to the extent necessary to enable all boundaries of every unit and the common property shown on the plan to be physically measured.
 Town Clerk.
 Bench Mark is located on bottom step outside Unit A, Level 55.4m based on Wellington Municipality Datum.
 Total Area 789 m².
 Comprised in 27.62/535 (All).
 Bruce Allen Page, Municipality of Lower Hutt Registered Surveyor and holder of an annual practicing certificate hereby certifies that this plan has been made from surveys executed by me or under my direction. That both plan and survey are correct and have been made in accordance with the regulations under the Survey Act 1985.
 Dated at Lower Hutt, this 15th day of January 1983.
 Field Book No. *18*, Traverse Book No. *0*.
 Reference Plans: D.P. 467, 1979, 4873, S.O. 2895.
 Examined & approved: *[Signature]*, District Engineer.
 Approved as to Survey: *[Signature]*, Chief Surveyor.
 Deposited this 15th day of 1983.
 Registered Land Registrar.
 No. 13, 5, 83.
 55016
 1:200
 Date JAN 1983
 LOCAL AUTHORITY WELLINGTON CITY
 Surveyed by BRUCE A. P. HANLEY
 Scale 1:200
 Date JAN 1983
 PLAN OF UNITS ON LOTS 14 & 15
 BLOCK F D.P. 467
 LAND DISTRICT WELLINGTON
 SURVEY BLK & DIST XI PORT NICHOLSON
 NTHS 261 SHEET NO. 227/3-4
 MGTN 748